

HERTFORDSHIRE COUNTY COUNCIL

THE HERTFORDSHIRE (PLAW HATCH CLOSE, BISHOP'S STORTFORD) (RESTRICTION OF WAITING) ORDER 2023

NOTICE is given that the Hertfordshire County Council has made an Order under the Road Traffic Regulation Act 1984 to introduce new waiting restrictions in parts of Bishop's Stortford as specified in the Schedules to this Notice. The Order will come into effect on Wednesday 10 July 2024.

Documents giving more detailed particulars of the Order are held on deposit and may be viewed from 27 June 2024 to 8 August 2024 during office hours at Main Reception, Hertfordshire County Council, County Hall, Pegs Lane, Hertford or online at www.hertfordshire.gov.uk/trafficorders by selecting East Herts and looking at Ref: EH00423.

Enquiries relating to the Order should be referred to the Highways Engineer concerned Tess Dowdeswell tel: 0300 123 4047 or tess.dowdeswell@hertfordshire.gov.uk

Any person wishing to question the validity of the Order, or of any provision contained in it, on the grounds that it is not within the powers conferred by the Road Traffic Regulation Act 1984, or on the grounds that any requirement of the Act or any Instrument made under it has not been complied with in relation to the Order, may within 6 weeks from the date of this Notice apply to the High Court for this purpose.

SCHEDULE 1: No waiting at any time – those sections of road listed below and as set out in the Order and scheme plan - Parts of Plaw Hatch Close.

SCHEDULE 2: No waiting 8.30am to 9.30am and 2.30pm to 3.30pm Monday to Friday – those sections of road listed below and as set out in the Order and scheme plan – Parts of Plaw Hatch Close.

County Hall
Hertford
Herts SG13 8DN

27 June 2024
Mark Doran
Executive Director, Growth and Environment

HERTFORDSHIRE COUNTY COUNCIL
ROAD TRAFFIC REGULATION ACT 1984

Date of Order: 17/06/2024

Order No: 8649

**THE HERTFORDSHIRE (PLAW HATCH CLOSE, BISHOP'S STORTFORD)
(RESTRICTION OF WAITING) ORDER 2023**

The Hertfordshire County Council in exercise of their powers under Sections 1, 2 and 3 of the Road Traffic Regulation Act 1984 (which said Act of 1984 is hereinafter referred to as "the Act of 1984"), and of all other enabling powers and after consultation with the Chief Officer of Police hereby make the following Order: -

1. This Order may be cited as "The Hertfordshire (Plaw Hatch Close, Bishop's Stortford) (Restriction of Waiting) Order 2023" and shall come into effect on Wednesday 10 July 2024.
2. The Hertfordshire (Plaw Hatch Close, Bishop's Stortford) (Restriction of Waiting) Order 2023 Plan numbered **EH00423P**, inclusive of its key, is incorporated into this Order, as listed in the Schedule to this Order.

3. **Interpretation –**

In this Order, except where the context otherwise requires, the following expressions have the meaning hereby respectively assigned to them;

"disabled person's vehicle" has the same meaning as in Section 142(1) of the Act of 1984;

"disabled person's badge" has the same meaning as given in Regulation 3(1) of The Local Authorities' Traffic Orders (Exemptions for Disabled Persons) (England) Regulations 2000

"parking disc" has the same meaning as given in Regulation 8(5) of The Local Authorities' Traffic Orders (Exemptions for Disabled Persons) (England) Regulations 2000; and

"relevant position" has the same meaning as given in Regulation 4 of The Local Authorities' Traffic Orders (Exemptions for Disabled Persons) (England) Regulations 2000

"postal packet" shall bear the same meaning as in Section 65 of the Postal Services Act 2011.

"provision of a universal postal Service" shall bear the same meaning as in Section 65 of the Postal Services Act 2011.

"universal service provider" shall bear the same meaning as in Section 65 of the Postal Services Act 2011.

4. Save as provided in Articles 6, 7 and 8 of this Order no person shall cause or permit any Vehicle to wait on areas of Road or sides of the road as shown on plan **EH00423P**, where waiting is not allowed as identified and shown on plan **EH00423P** and its key thereof.
5. Save as provided in Articles 6, 7 and 9 of this Order no person shall cause or permit any vehicle to wait on areas of road or sides of the road as shown on plan **EH00423P**, where waiting is not allowed between 8.30am to 9.30am and 2.30pm to 3.30pm on Monday to Friday as identified and shown on plan **EH00423P** and the key thereof.
6. Nothing in Articles 4 and 5 of this Order applies in relation to -
 - (a) a vehicle being used for Fire and Rescue, Ambulance or Police purposes.
 - (b) anything done with the permission of or at the direction of a Police Constable in uniform, or with permission of a Civil Enforcement Officer as defined by the Traffic Management Act 2004 and appointed by East Hertfordshire District Council.

- (c) a vehicle which is being used for one or more of the following purposes and which cannot reasonably be used for such a purpose;
 - (i) any operation involving building, demolition or excavation;
 - (ii) the removal of any obstruction to traffic;
 - (iii) the maintenance, improvement or reconstruction of a road;
 - (iv) constructing, improving, maintaining, or cleaning of any street furniture; or
 - (v) the laying, erection, alteration, repair or cleaning of any sewer or of any main pipe or apparatus for the supply of gas, water or electricity, or of any telecommunications apparatus kept or installed for the purposes of a telecommunications code system or of any other telecommunications apparatus lawfully kept installed in any position.
 - (d) a marked vehicle which, whilst used by a universal service provider in the course of the provision of a universal postal service, is waiting only for long as is reasonably necessary to enable postal packets to be delivered or collected.
7. Nothing in Articles 4 and 5 of this Order applies to the lengths of road restricted by that Article, as identified on plan **EH00423P** so as to render it unlawful to cause or permit any vehicle to wait only for so long as may be reasonably necessary –
- (a) to enable goods to be loaded on or unloaded from the vehicle from or to premises adjacent to the restricted area; or
 - (b) to enable a passenger to board or alight and to load and unload any luggage.
8. Nothing in Article 4 of this Order shall render it unlawful to cause or permit a disabled person's vehicle which displays in the relevant position a disabled person's badge and a parking disc, to wait at any time in the lengths of road restricted by that Article for a period not exceeding 3 hours (not being a period separated by an interval of less than 1 hour from a previous period of waiting by the same vehicle in the same length of road).
9. Nothing in Article 5 of this Order shall render it unlawful to cause or permit a disabled person's vehicle which displays in the relevant position a disabled person's badge and a parking disc, to wait at any time in the lengths of road restricted by that Article.
10. The restrictions imposed by this Order shall be in addition to and not in derogation from any restriction or requirement imposed by any other regulations made or having effect as if made under the Act of 1984 or by or under any other enactment.
9. The Interpretation Act 1978 shall apply for the interpretation of this Order as it applies for the interpretation of an Act of Parliament.

SCHEDULE

Schedule	Plan – EH00423P
----------	-----------------

Signed:

Charlotte McKay

Charlotte McKay
Assistant Chief Legal Officer
Environment Law / Legal Services

Dated: 17/06/2024

STATEMENT OF REASONS

THE HERTFORDSHIRE (PLAW HATCH CLOSE, BISHOP'S STORTFORD) (RESTRICTION OF WAITING) ORDER 2023

Hertfordshire County Council is proposing to introduce new waiting restrictions in parts of Bishop's Stortford.

The proposals will comprise of –

- 'No waiting at any time' restrictions on parts of Plaw Hatch Close.
- 'No waiting 8.30am to 9.30am and 2.30pm to 3.30pm Monday to Friday' restrictions on parts of Plaw Hatch Close.

Vehicles have been recorded parking close to junctions and inappropriately along this part of Plaw Hatch Close. These problems particularly occur at school pick up and drop off times. These proposals are to prevent vehicles parking inappropriately, and ensuring visibility of vehicles and pedestrians is maintained whilst keeping the road clear so passage of vehicles is unrestricted.

Parked vehicles in the vicinity of the junction and along this part of Plaw Hatch Close cause issues of obstruction and visibility of pedestrians and vehicles. The proposed TRO would aim to secure the convenient and safe movement of vehicles and pedestrians. Adequate parking facilities on and off the highways would still be available.

Following statutory consultation, the responses received to the proposals have been considered and recommendation and decision taken to reduce the restrictions on the eastern side of Plaw Hatch Close.

Therefore, having also considered the duty imposed under Section 122 Road Traffic Regulation Act 1984, it appears to the Highway Authority that it is necessary and expedient to make an Order in the interests of avoiding danger to persons or other traffic using the road and for preventing the likelihood of any such danger arising and for facilitating the passage on the road or any other road of any class of traffic (including pedestrians).

The proposal has been subject to consultation with local and County Councillors representing the area and East Hertfordshire District Council. The local Police, Ambulance, Fire & Rescue Services, Hertfordshire County Council Passenger Transport Unit, Bishop's Stortford Town Council and local residents are also being consulted.

**THE HERTFORDSHIRE (PLAW HATCH CLOSE, BISHOP'S STORTFORD)
(RESTRICTION OF WAITING) ORDER 2023 - PLAN EH00423P**

Signed:

Charlotte McKay

**Charlotte McKay
Assistant Chief Legal Officer**

Dated: 17/06/2024



100mm
50
20
10mm
0

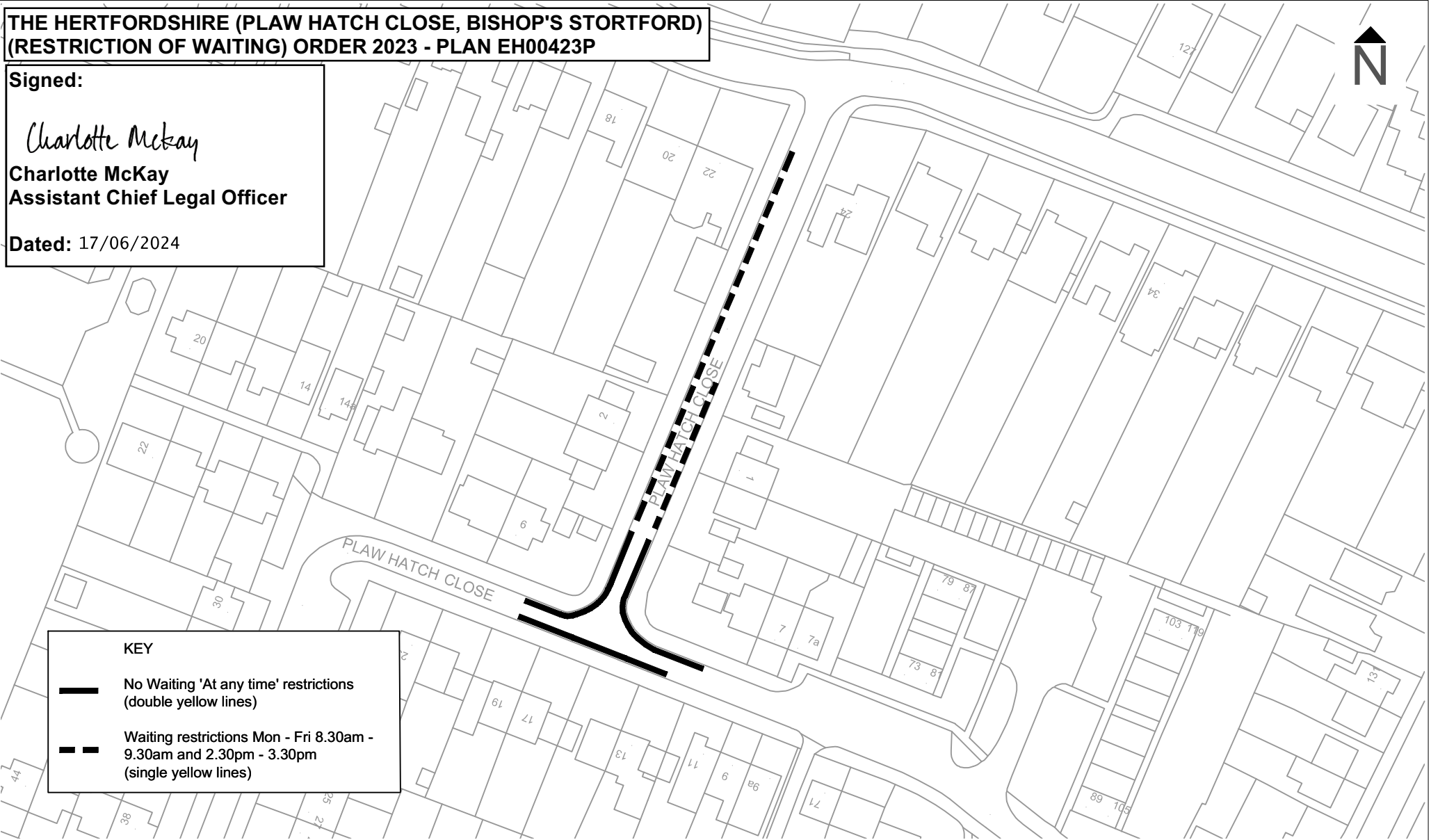

KEY

 No Waiting 'At any time' restrictions
(double yellow lines)

 Waiting restrictions Mon - Fri 8.30am -
9.30am and 2.30pm - 3.30pm
(single yellow lines)

Rev	Date	Description of Revisions	Drawn	Chkd	Appr
A	14/02/23	Addition of single yellow line	TD	GT	IH
B	09/02/24	Reduction of single yellow line	TD	GT	IH



County Hall
Pegs Lane
Hertford, Herts
SG13 8DN
www.hertfordshire.gov.uk/highways

Notes
N1. You are not permitted to copy, sub-licence, distribute or sell any of this data to third parties in any form. (This restriction may not apply to HCC and its licensed contractors, agents & partners.)
N2. © Crown copyright and database right to 2022 Ordnance Survey 100019606.

Drawn	Designed	Checked	Approved	Approved Date
MN	MN	MN	IH	FEB 21
Signature	Signature	Signature	Signature	Scale(s)
				1:1000

Project	
PLAW HATCH CLOSE BISHOP'S STORTFORD DIVISION 17	
Sheet	
THE HERTFORDSHIRE PLAW HATCH CLOSE, BISHOP'S STORTFORD RESTRICTION OF WAITING ORDER 2023	
Project No.	Sheet No.
CH.77001038.Y9.17.PHC	1
Revision	Revision
	A